

relative location of rooms within dashed lines may be different

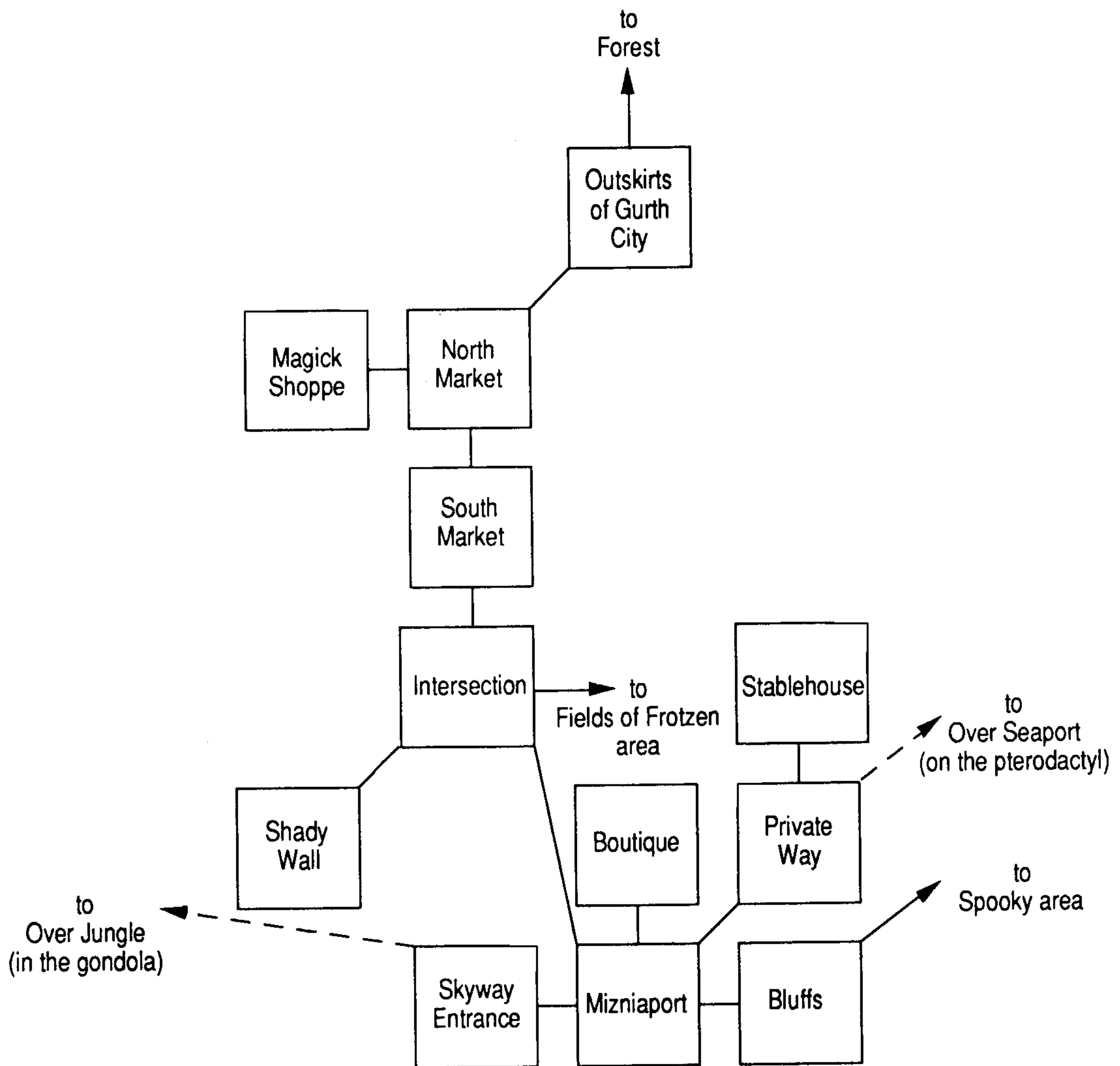

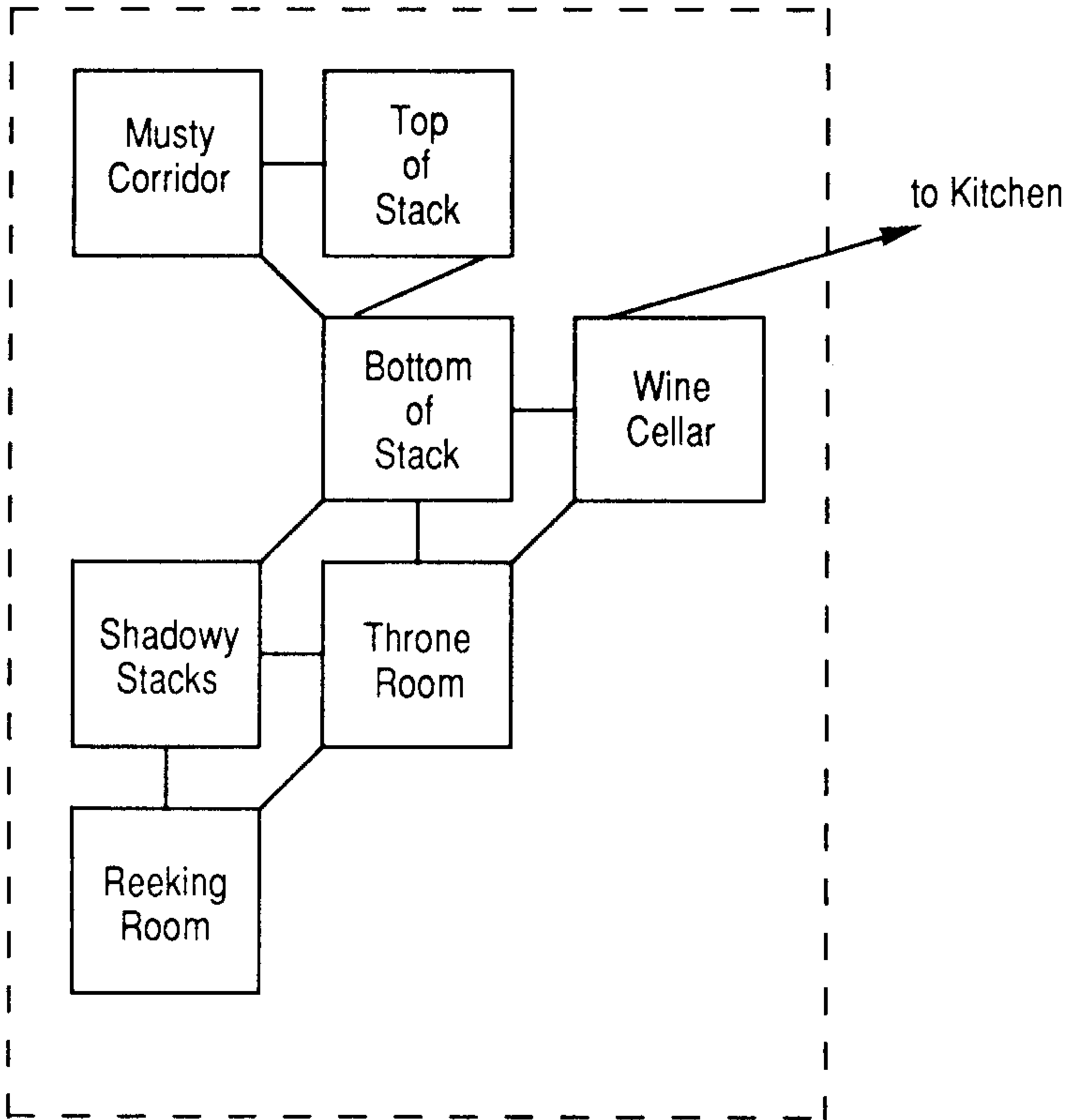

relative location of rooms within dashed lines may be different

Plane of  
Trans-  
Infinite  
Splendor

Lamp  
Room

Dusty  
Corner

Saggy  
Floor

Dimly-Lit  
Room

Lighthouse,  
3rd Level

Chamber  
of  
Light

Twilit  
Room

Saggy  
Ceiling

Lighthouse,  
2nd Level

Room  
of  
Gloom

Crumbling  
Walls

Creaky  
Corner

Lighthouse,  
1st Level

to Lighthouse

relative location of rooms within  
dashed lines may be different

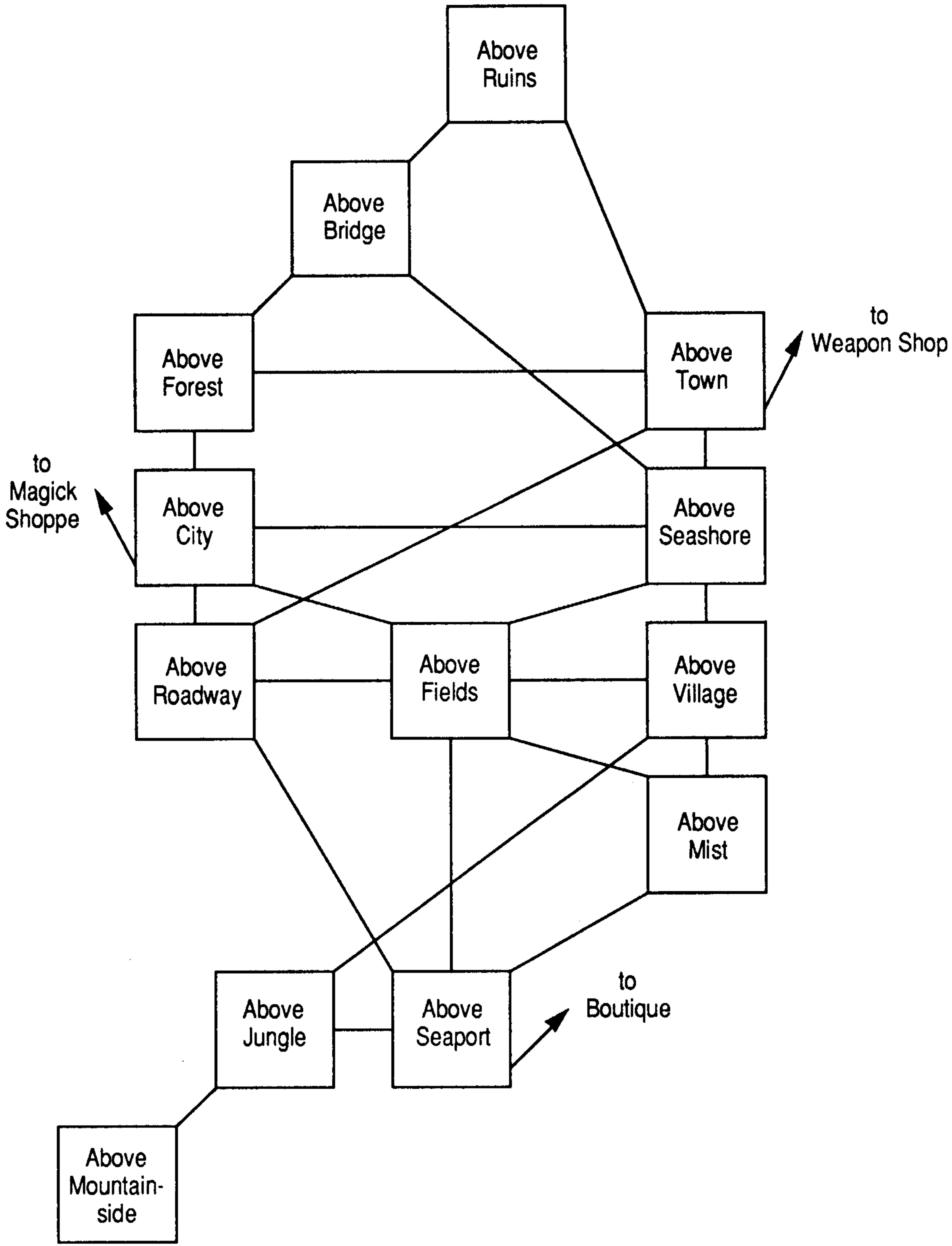

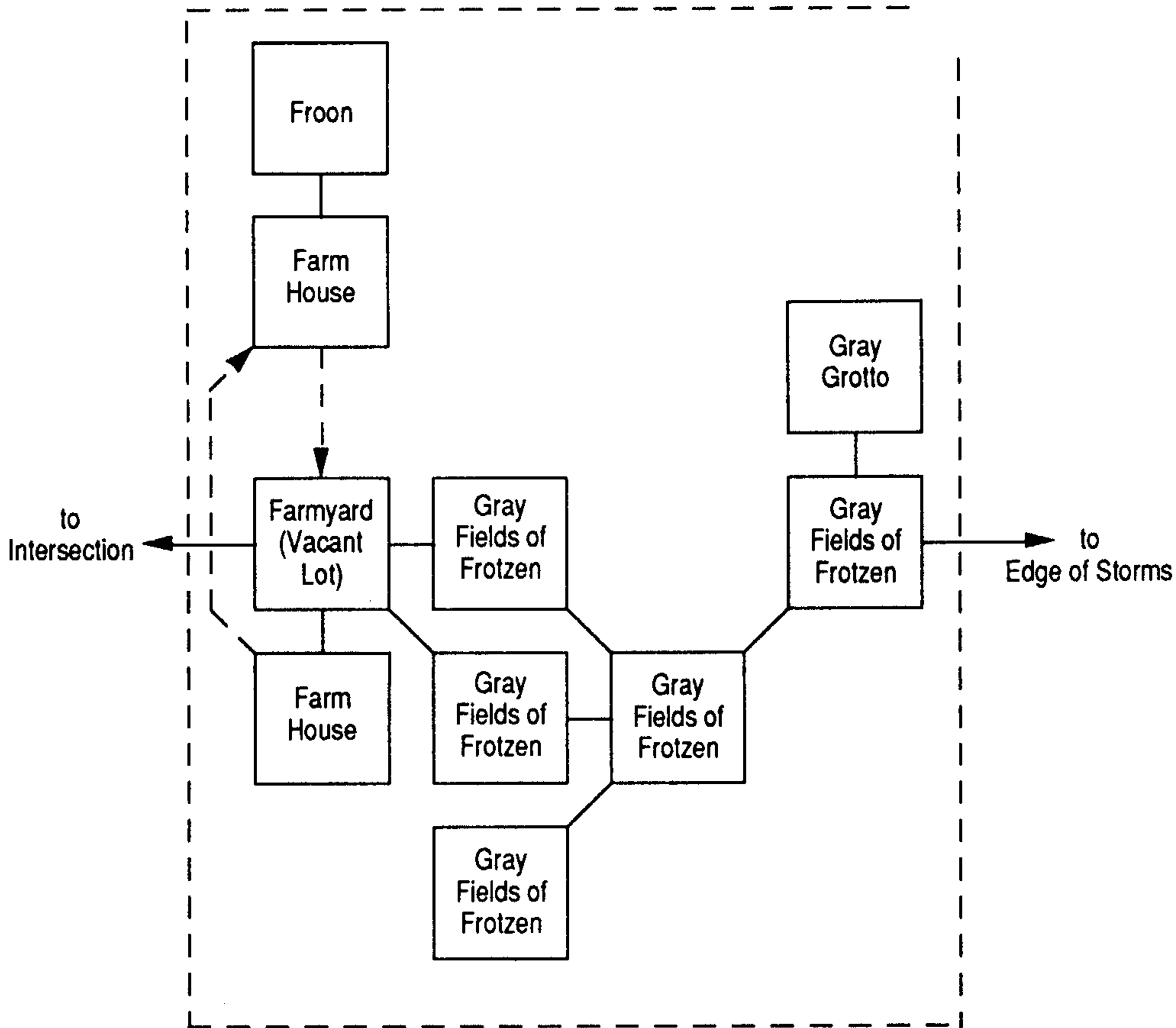

relative location of rooms within dashed lines may be different

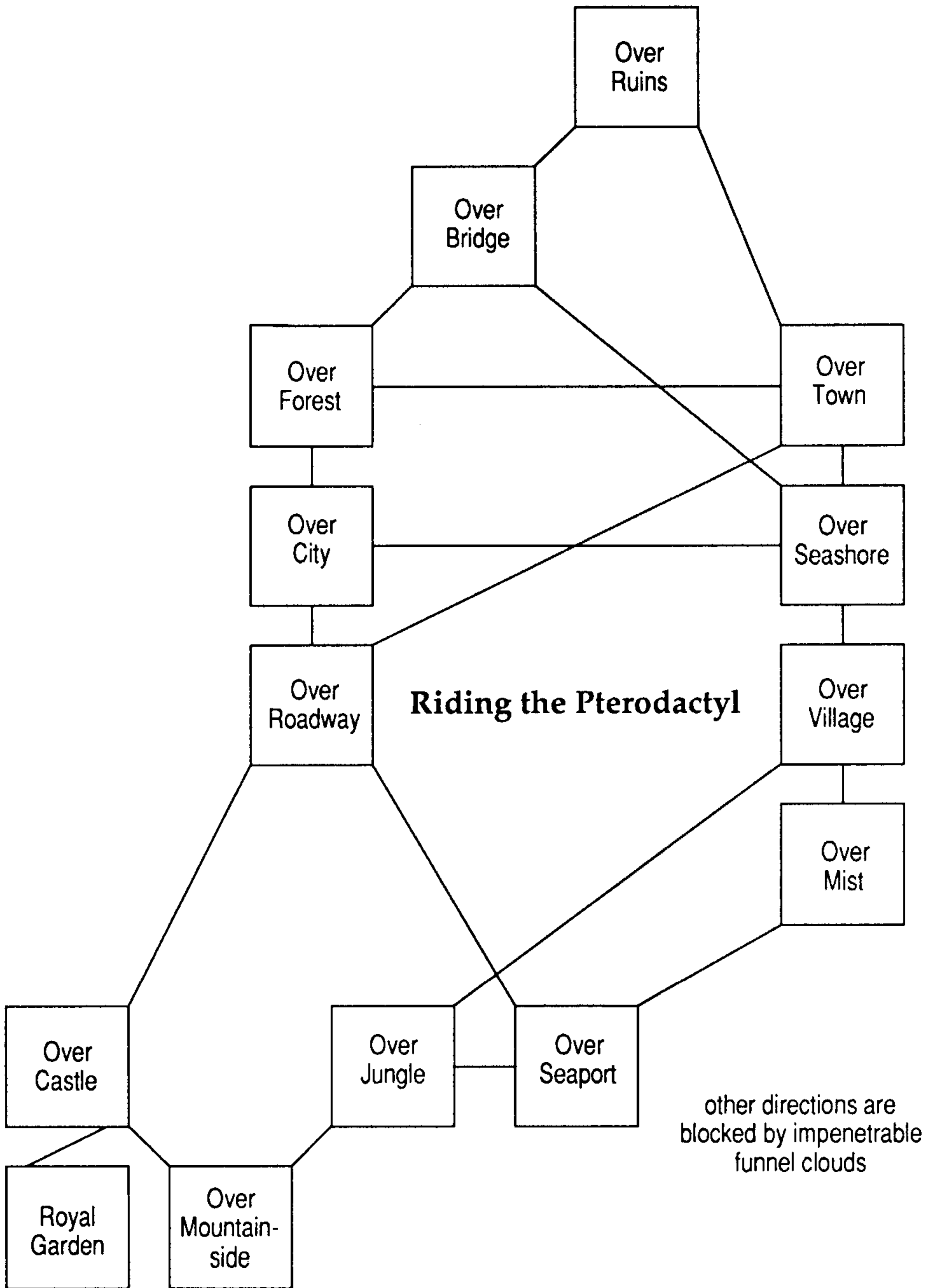



# Jungle

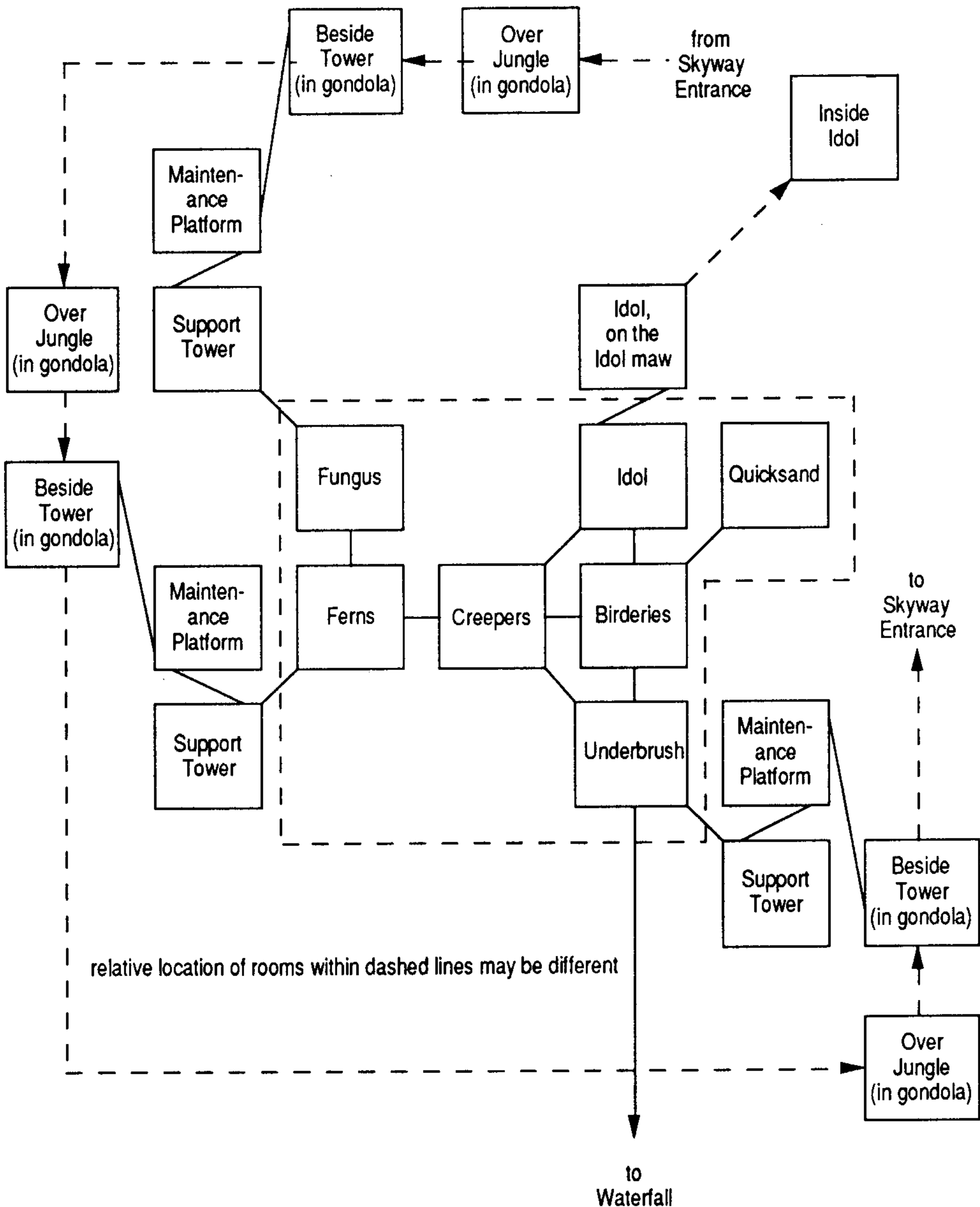

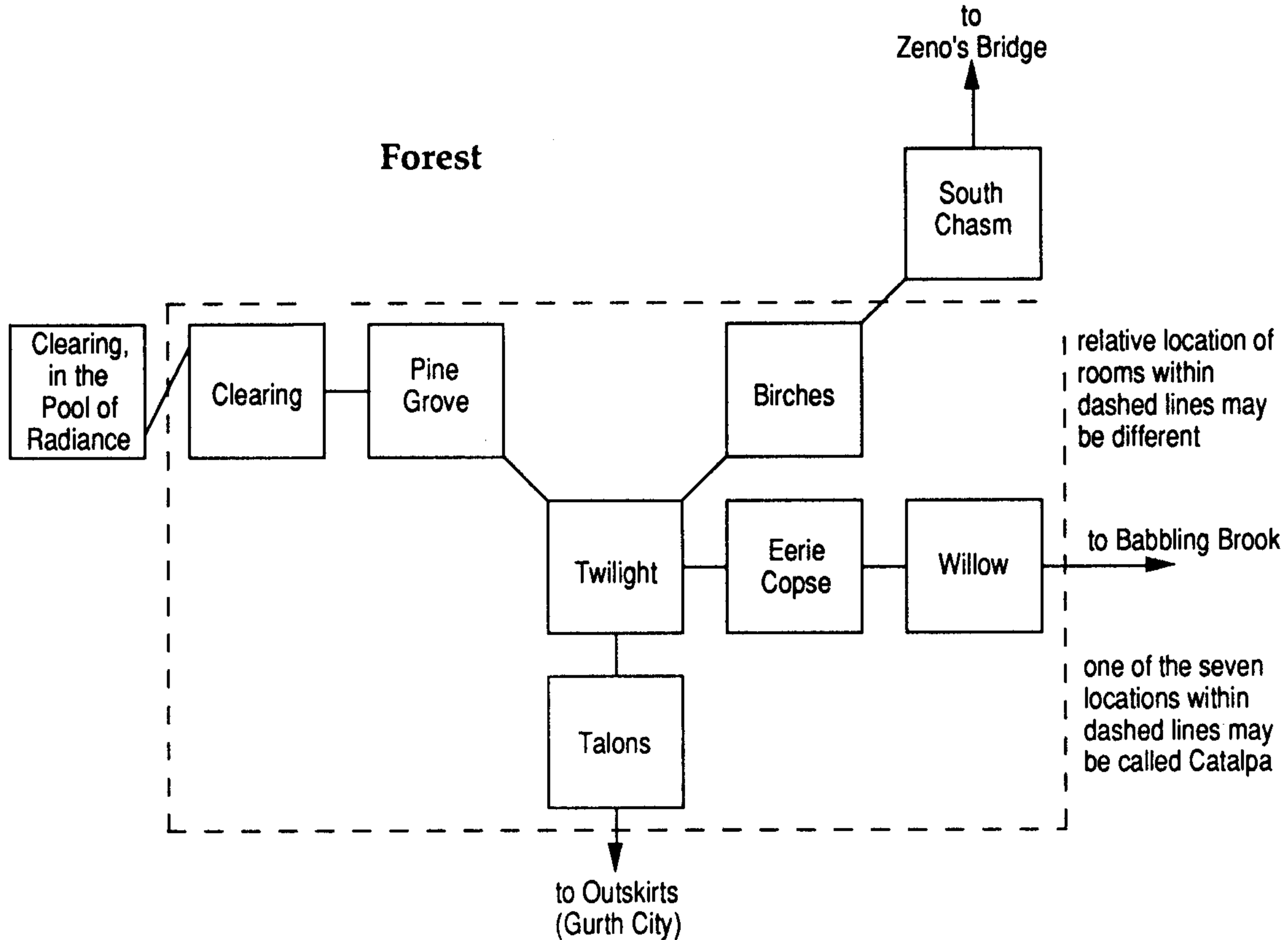

# Mountain Area

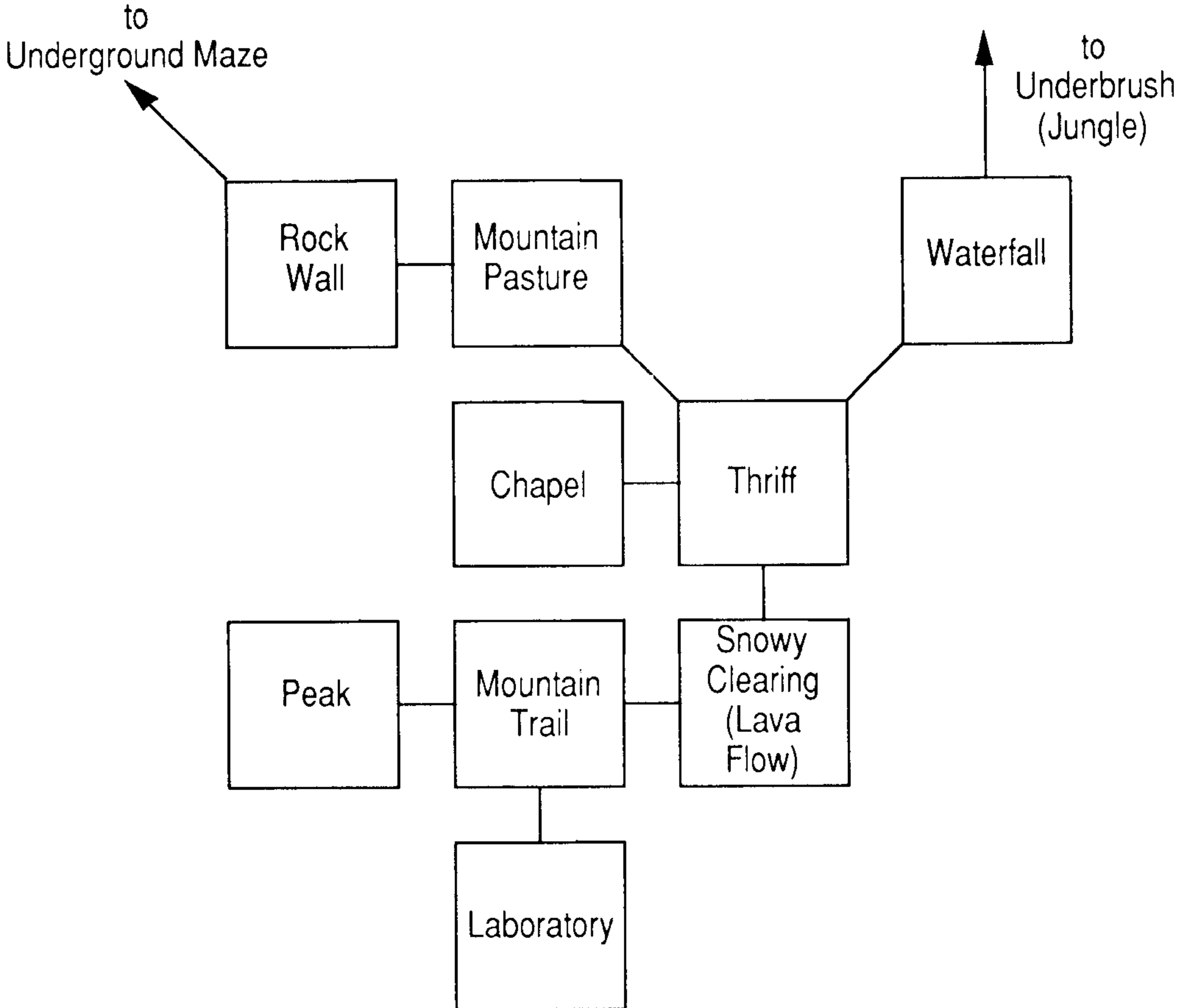

# Ruins

relative location of rooms within dashed lines may be different

from  
Over Ruins

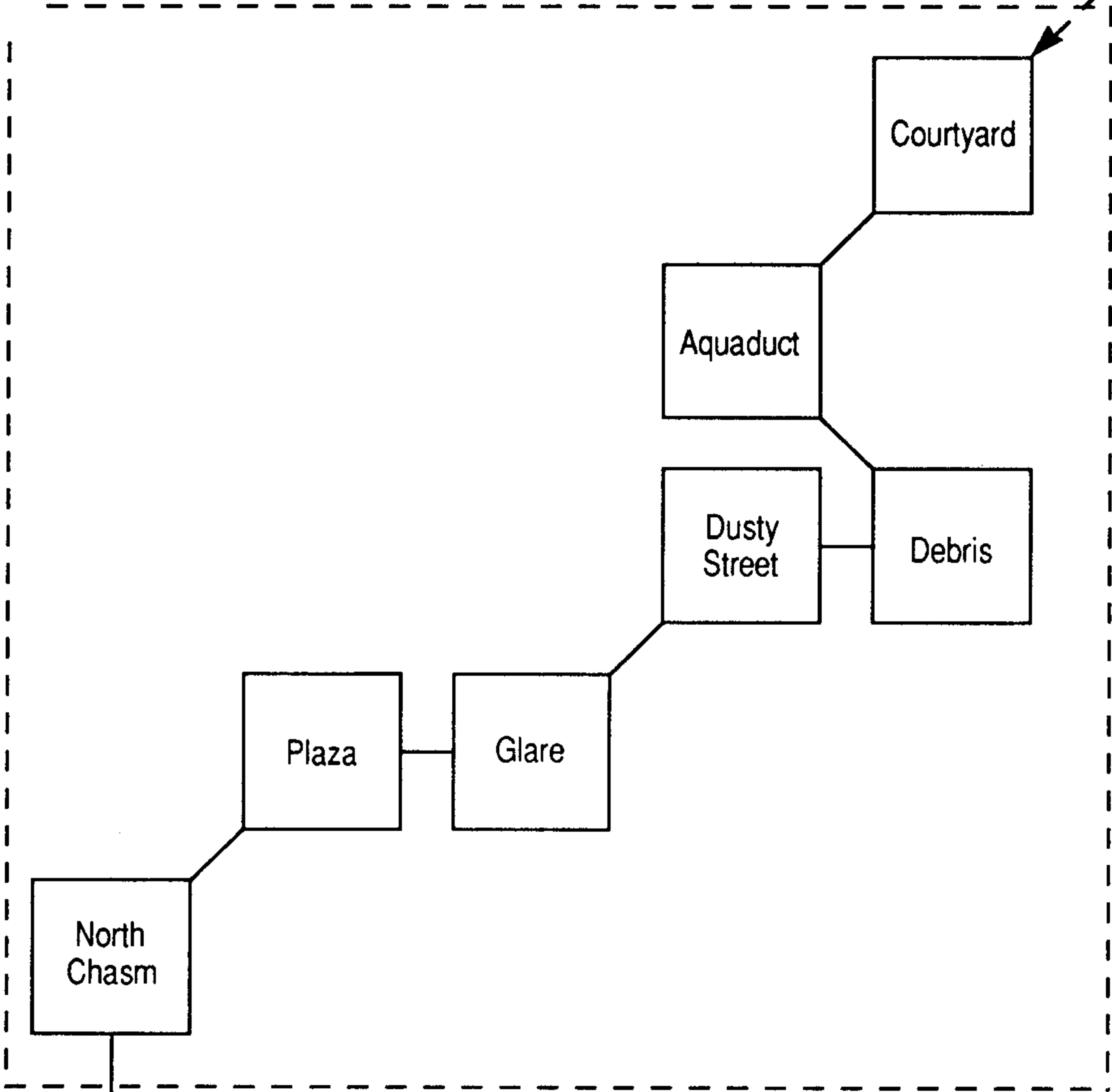

to  
Zeno's Bridge

# Underground Maze

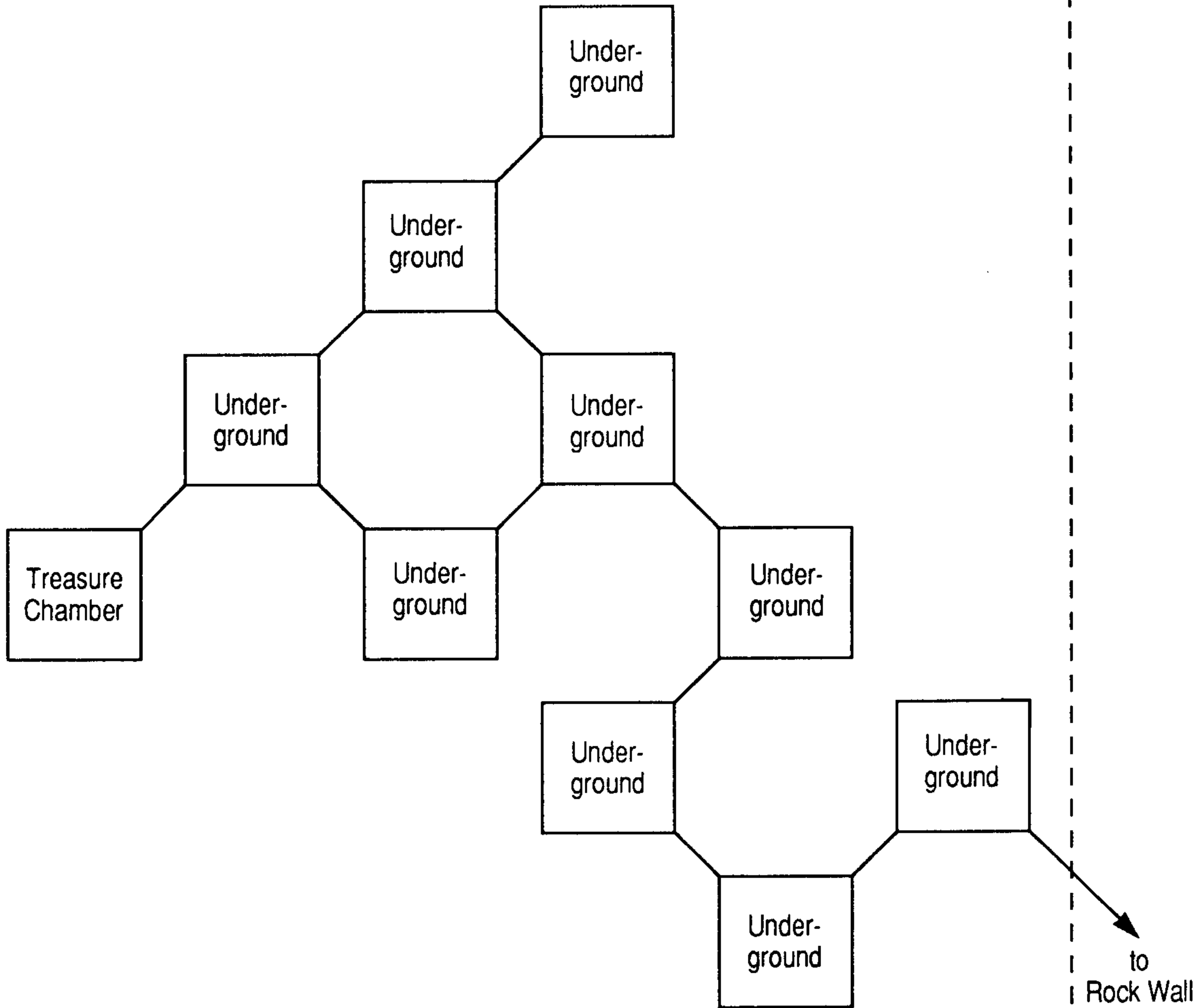

relative location of rooms within dashed lines may be different

# Under the Arch

